

Utilization Codes	
01 - Office	
02 - Classroom/Labs/Lecture Halls	
03 - Bathrooms	
04 - Mechanical Room/Chases	
05 - Living Quarters	
06 - Storage	
07 - Halls; Entrances	
08 - Stairs & Elevators	
09 - Workrooms	
10 - Kitchens & Dining Rooms	
11 - Conference Rooms	
12 - Special Purpose (Gyms, Darkrooms, Museums, etc.)	
13 - Other	

1st Floor Space Utilization Matrix per Code	
01 - 6,836 sq. ft.	
02 - 0 sq. ft.	
03 - 416 sq. ft.	
04 - 1,604 sq. ft.	
05 - 0 sq. ft.	
06 - 818 sq. ft.	
07 - 1,742 sq. ft.	
08 - 232 sq. ft.	
09 - 105 sq. ft.	
10 - 58 sq. ft.	
11 - 699 sq. ft.	
12 - 0 sq. ft.	
13 - 0 sq. ft.	
1st Floor Total - 12,510 sq. ft.	

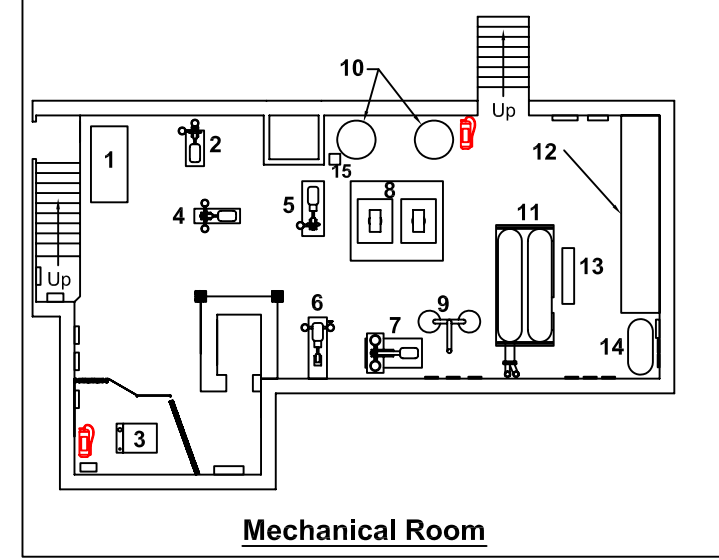

OVERSTREET HALL FLOOR UTILIZATION MATRIX				
Utilization Code	1st Floor	2nd Floor	3rd Floor	Totals
01	6,836	3,245	1,204	11,285
02	-	465	-	3,366
03	416	400	400	1,216
04	1,604	126	198	1,928
05	-	-	-	-
06	818	790	644	2,252
07	1,742	3,200	2,091	7,033
08	232	280	157	669
09	105	514	506	1,125
10	58	-	776	834
11	699	525	-	1,224
12	-	1,270	-	1,270
13	-	-	-	-
Totals	12,510	10,815	9,342	32,667

- Legend for Mechanical Room**
- 1 - Blank Pad
 - 2 - Hot Water Pump for Harton
 - 3 - Elevator Motor Pump
 - 4 - Chilled Water Pump
 - 5 - Primary Chiller Pump
 - 6 - Condenser Pump
 - 7 - Building Pump
 - 8 - Boilers
 - 9 - Sump
 - 10 - Expansion Tanks
 - 11 - Chiller
 - 12 - Transformer Motor Control Center
 - 13 - Control for Chiller
 - 14 - Air Compressor
 - 15 - Blank Pad

Overstreet Floor Schedule (1st Floor)

Utilization Code	Space	Overall Dims. (Length x Width)	Sq. Ft.	Utilization Code	Space	Overall Dims. (Length x Width)	Sq. Ft.	Utilization Code	Space	Overall Dims. (Length x Width)	Sq. Ft.	Utilization Code	Space	Overall Dims. (Length x Width)	Sq. Ft.
01	10	16'-9"; 25'-6"	416.26	10	100B	6'-0"; 9'-11"	58.25	06	106C	10'-6"; 16'-4"	171.50	01	114	24'-10"; 61'-0"	1090.60
06	10A	3'-10"; 7'-4"	28.11	06	100C	8'-3"; 6'-2"	50.88	01	107	12'-6"; 11'-0"	137.50	01	114A	15'-3"; 90'-8"	144.64
01	12	12'-7"; 9'-6"	119.55	01	101	24'-0"; 14'-0"	296.50	01	107A	11'-8"; 20'-0"	230.95	06	114B	9'-2"; 6'-1"	55.76
01	14	16'-0"; 16'-6"	264.91	11	102	29'-0"; 24'-2"	698.56	06	107B	12'-6"; 8'-6"	105.75	06	114C	7'-0"; 6'-0"	42.50
01	15	12'-0"; 11'-4"	136.00	01	103	10'-6"; 30'-1"	315.88	07	110	24'-8"; 12'-4"	304.22	01	114D	4'-3"; 26'-2"	111.21
01	17	12'-0"; 11'-10"	142.00	01	103A	13'-0"; 15'-10"	205.83	07	110A	9'-4"; 53'-5"	492.68	06	114E	2'-6"; 2'-3"	5.63
01	19	12'-0"; 10'-10"	130.00	01	103B	13'-0"; 9'-5"	122.42	07	110B	9'-4"; 42'-6"	396.00	01	115	10'-11"; 25'-4"	270.64
01	20	11'-10"; 17'-6"	201.34	01	103C	13'-0"; 9'-10"	127.28	07	110C	8'-2"; 22'-11"	181.81	01	115A	13'-1"; 19'-0"	208.83
01	21	12'-0"; 22'-0"	264.00	06	103D	10'-6"; 5'-8"	59.50	07	110D	7'-10"; 18'-6"	144.92	01	115B	13'-1"; 13'-6"	174.68
07	Entrance	7'-6"; 12'-0"	137.68	04	104	4'-0"; 7'-7"	30.33	03	111	17'-4"; 9'-4"	152.61	06	115C	9'-2"; 6'-1"	55.76
07	E. Hall	3'-10"; 11'-2"	42.81	03	105	23'-8"; 9'-0"	198.27	03	111A	7'-2"; 3'-8"	26.28	06	115D	4'-0"; 3'-1"	12.33
07	W. Hall	3'-10"; 10'-10"	41.47	09	106	10'-6"; 11'-0"	105.39	01	112	9'-0"; 19'-10"	176.88	01	116	9'-4"; 17'-10"	154.69
01	100	22'-7"; 17'-4"	391.44	01	106A	13'-0"; 16'-6"	213.61	01	112A	15'-3"; 9'-9"	144.69	01	116A	15'-1"; 16'-9"	252.65
03	100A	5'-9"; 6'-11"	39.27	06	106B	13'-0"; 11'-0"	143.00	06	113	7'-8"; 5'-8"	43.44	01	116B	17'-8"; 15'-0"	264.11



Overstreet Hall	
1st Floor	
SCALE: None	DRAWN BY: Mark F.
DATE: 4-30-09	DRAWING NO.: 1 of 3